

LED SIMPLE LAMP

LED KING PROVIDES SIMPLE ECO-LIGHTING FOR SMALL LIGHT.

Our simple lamp series are ideal for decorative or spot lighting. The lampbody is made of aluminum/ stainless steel and anticorrosive.



FLOORLED 3x1W 12-24V series



Portfolio A

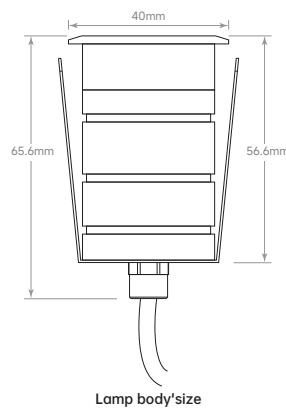

Lamp body's size

Portfolio B

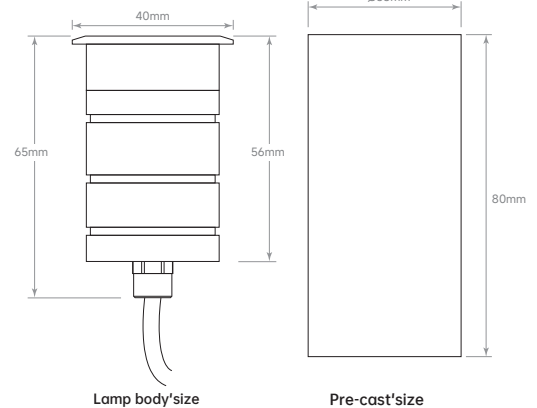

Pre-cast's size

Part No of LED King	12V		24V		Lumen (Lm)	Colour	CRI	IP Rang	Beam Angle
	Power	Current	Power	Current					
FL-3X1W1224WW	3W	0.26A	3W	0.13A	280	3000K	>93	IP67	15°
FL-3X1W1224CW					320	6000K			30°
FL-3X1W1224NW					300	4000K			60° 90°

Lighting Installation(Portfolio A)

1 Digging a suitable hole and wire casing on the ground based on the size of pre-cast.

2 Taking apart the lamp body from the pre-cast.

3 Putting the pre-cast into the hole.

4 Inserting the lamp body to the pre-cast, then fix screw and lay out the line.

Connector for LED In Ground Light

1.0-1.5m

The installation sketch map of connector for LED In Ground Light



Lighting Installation(Portfolio B)

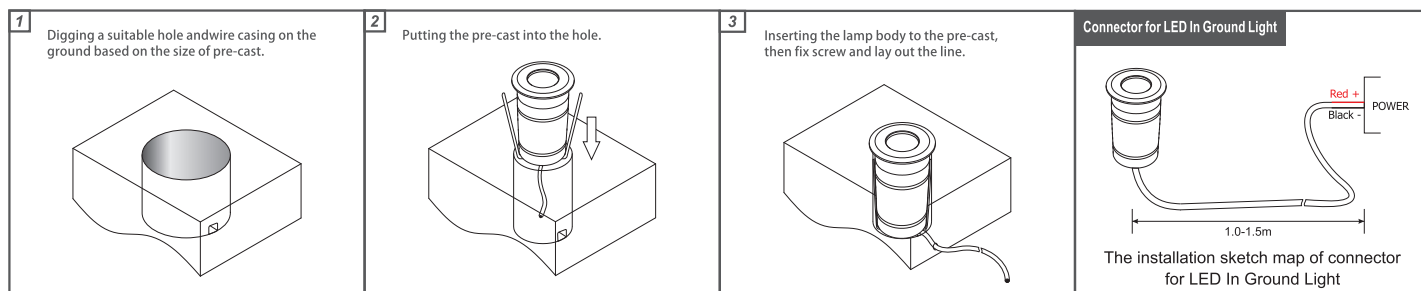

Packing Specification

Type	Net Weight	QTY	Gross Weight	Demension
FL-3X1W1224	0.14kg	100PCS	16.2kg	485x215x250mm

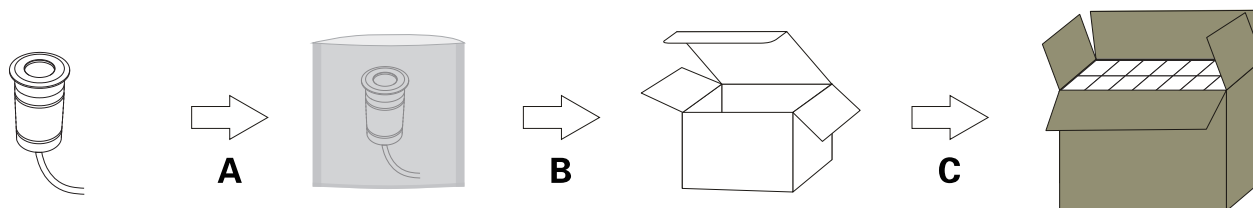

A: 1 pcs LED in ground light Inside a pe bag.

B: After 10 PE bag with LED in ground light into a box.

C: Put the 10 box on outer container.